



THE MURRAY BOARDROOMS



LEVEL 2

The Murray Boardrooms

In each of the three ultra-smart rooms, natural daylight cascades through the oversized windows that grace and exemplify the building's iconic façade.

Each boardroom can accommodate up to twenty persons. Each of them are equipped with 65" TV screens, video conference facilities and are self-contained, making them a perfect location for private meetings or special events.

If a larger space or zoning is required, adjacent rooms can be interconnected.

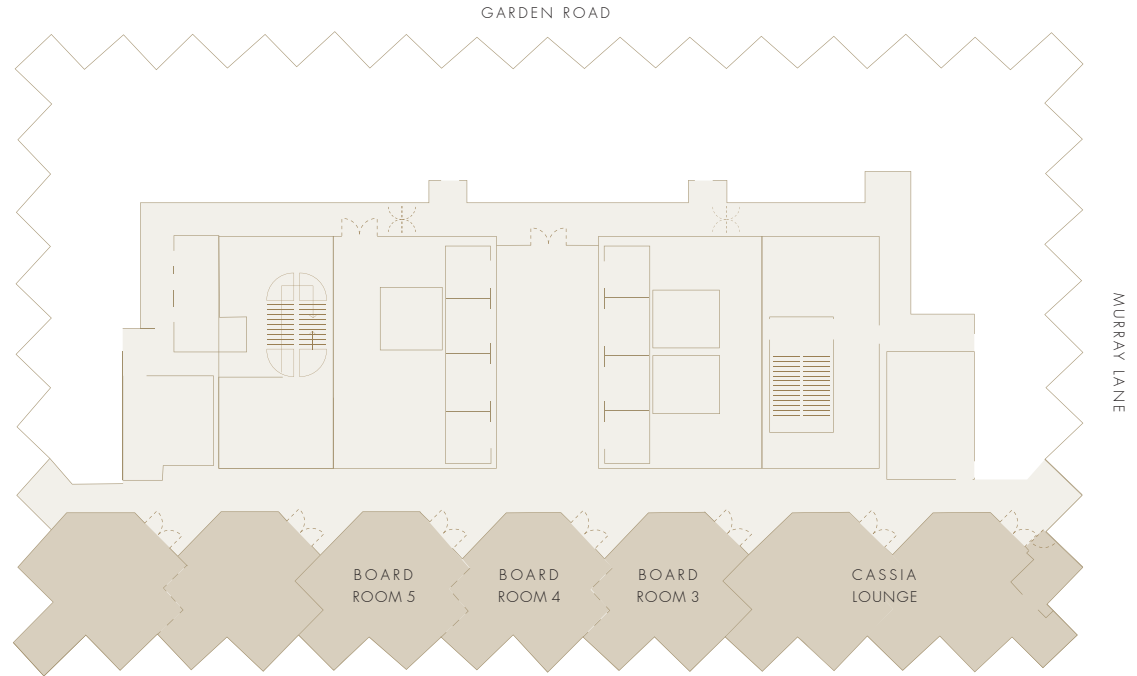

Venue	Set Up					Area		Headroom	
	Boardroom	U-Shape	Theatre	Classroom	Cocktail	Sqm	Sqf	H(m)	H(f)
BOARDROOM 3	12	15	20	12	20	35	380	2.4	8
BOARDROOM 4	12	15	20	12	20	36	390	2.4	8
BOARDROOM 5	12	15	20	12	20	38	410	2.4	8

THE MURRAY

HONG KONG

A NICCOLO HOTEL

Capacities are indicative and subject to regulation approval.