



GARDEN LOUNGE



## GARDEN LEVEL

### Garden Lounge

With floor-to-ceiling windows overlooking the picturesque St John's Cathedral, and more than a hint of sophistication, the elegant Garden Lounge on the Upper Ground level serves signature afternoon teas alongside a refreshing all-day menu featuring familiar Western and Asian signatures and an evening of seafood indulgence. The lounge exudes contemporary aesthetics of cool grey and gold accents and offers outdoor seating by the lush lawn, available for those who prefer a relaxed setting or who are visiting with pets. The versatile layout and professional service also make the Garden Lounge an ideal venue for business meetings.

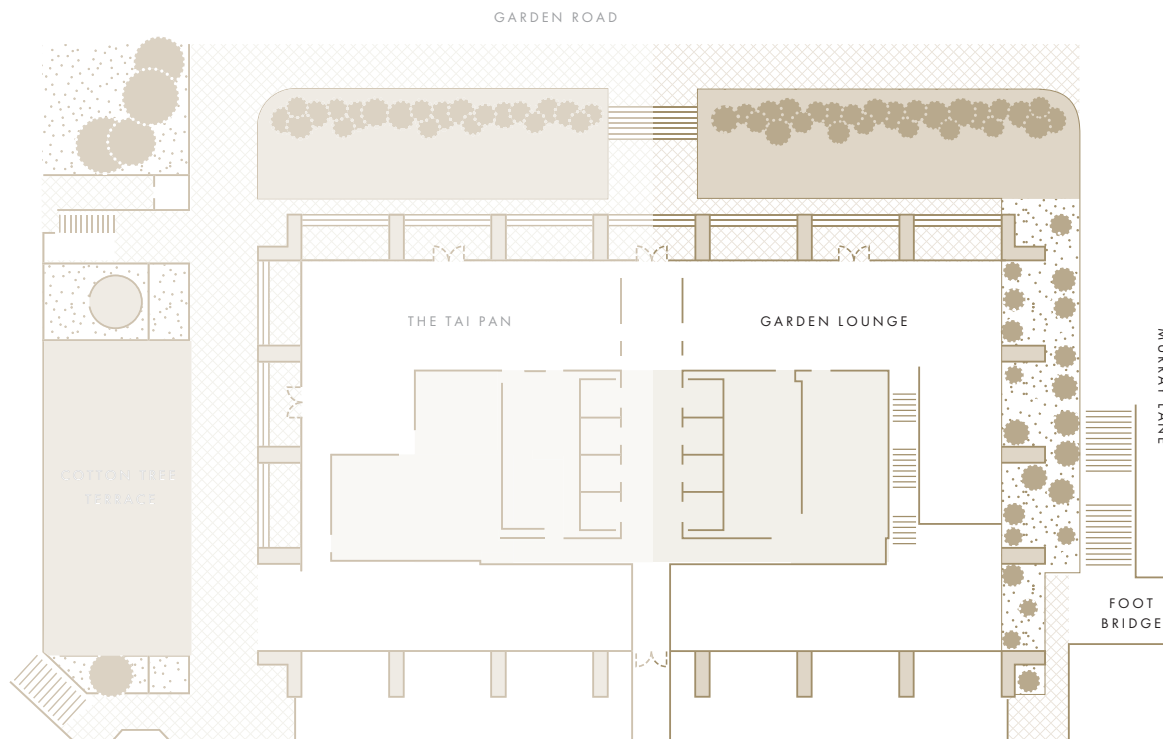

# THE MURRAY

HONG KONG

A NICCOLO HOTEL

Venue	Outdoor	Indoor
<b>THE GARDEN LOUNGE</b>	24 seats 80 sqm 860 sqf	60 seats 175 sqm 1875 sqf

Capacities are indicative and subject to regulation approval.